



C7CARBON INSTALLATION GUIDE

BRAND Chevrolet **MODEL** Camaro SS

YEAR 2016 and up

PART NAME ZL1 1LE style Rear Wing

PART NUMBERS C7- CC6- ZL1- RW-CF

C7- CC6- ZL1- RW-FRP

C7- CC6- ZL1- RW-SB

C7- CC6- ZL1- RW-GB

www.C7carbon.com

C7CARBON-INSTALLATION GUIDE

BRAND Chevrolet MODEL Camaro SS
PART NAME ZL1 1LE style Rear Wing
PART BUMPERS C7- CC6- ZL1- RW-CF
C7- CC6- ZL1- RW-SB

YEAR 2016 and up
C7- CC6- ZL1- RW-FRP
C7- CC6- ZL1- RW-GB

1

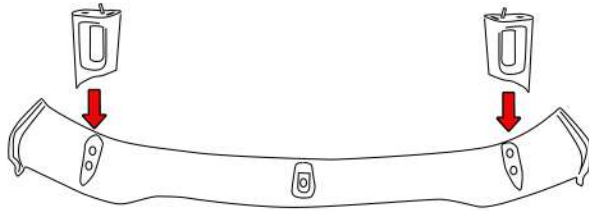

- Carefully place the wing blade upside down on a smooth flat surface, making sure that the mounting points on the wing blade are facing upwards.
- Place driver and passenger side uprights on the wing's mounting points, as shown on the illustration.

2

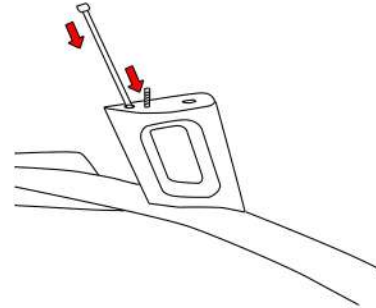

- On the driver and passenger side mounting points, begin by placing a short bolt on the front hole for each upright.

NOTE:

The length on this bolt varies depending on the upright height option selected for the wing:

- 4.5" bolt for short version uprights.
- 6.0" bolt for tall version uprights.

3

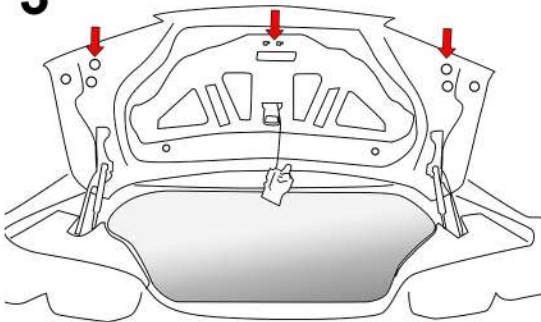

- Remove the trunk latch as well as the driver and passenger side plastic covers that are located on the trunk lid's underside in order to have access to the rear spoiler's bolting points.

4

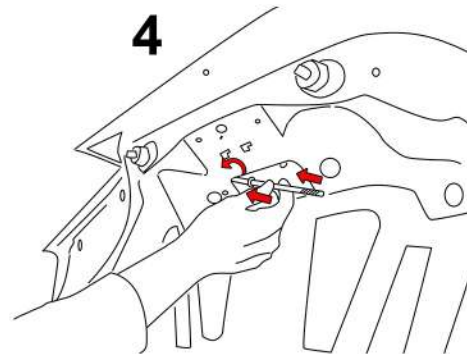

- Place one washer on one of the long bolts that comes included in the wing's hardware kit.
- Slide in the long bolt through the back hole in the center of the trunk, making sure that the bolt goes all the way and sticks out on the top of the trunk lid.

NOTE: The length on the longer bolt varies depending on the upright version:

- 5.5" for short version uprights.
- 7.0" for tall version uprights.

www.C7carbon.com

Page 1 of 3

PLEASE NOTE: All parts must be prepped and installed by a professional body shop that has experience working with carbon fiber and fiberglass car parts including but not limited to cutting, filling, sanding and shaving. Extra fees can be incurred for proper fitment. All parts are sold for off-road and show use only. We do not accept liability for injuries resulting from customization of buyer/owners car, this is done at their own risk. You, as the buyer, are responsible for complying with any/all local, state and federal laws.

C7 CARBON-INSTALLATION GUIDE

BRAND Chevrolet MODEL Camaro SS
PART NAME ZL1 1LE style Rear Wing
PART BUMPERS C7- CC6- ZL1- RW-CF
C7- CC6- ZL1- RW-SB

YEAR 2016 and up

C7- CC6- ZL1- RW-FRP
C7- CC6- ZL1- RW-GB

5

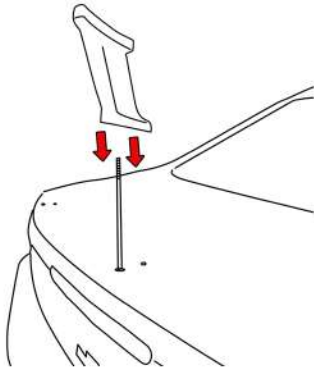

- Place the center upright on the trunk lid.
- The threaded stud that is sticking out on the bottom of the upright will go through the front hole located in the center of the trunk lid.
- Make sure that the bolt passes through the center upright all the way until it sticks out from the top section of the upright.

6

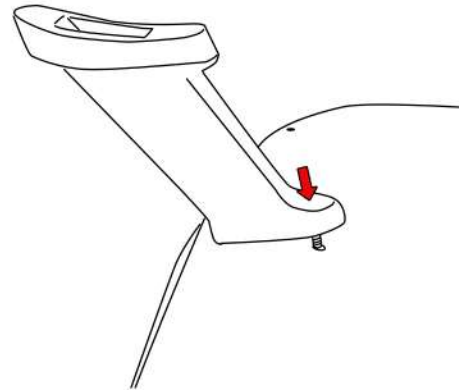

- Once the upright's bottom stud goes through the trunk lid's hole, the stud can be secured by placing the washer and nut on it from underneath the trunk lid.

7

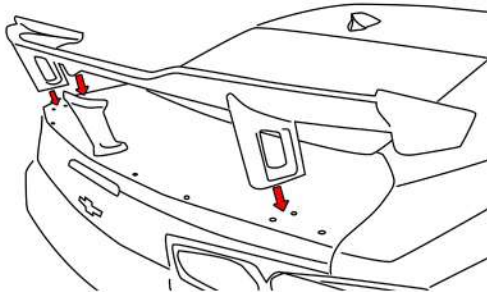

- Place the wing (with the driver and passenger side uprights already assembled on it) on top of the trunk and center upright, making sure that the threaded studs that stick out from the bottom of the driver and passenger side uprights go through the trunk lid's pre-drilled holes up front.

8

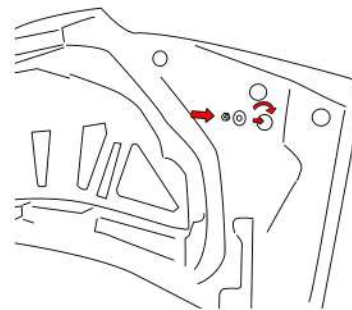

- Install the washer and nut on the threaded stud of the driver and passenger side uprights that went through the trunk lid pre-drilled hole.

C7CARBON-INSTALLATION GUIDE

BRAND Chevrolet MODEL Camaro SS
PART NAME ZL1 1LE style Rear Wing
PART BUMPERS C7- CC6- ZL1- RW-CF
C7- CC6- ZL1- RW-SB

YEAR 2016 and up
C7- CC6- ZL1- RW-FRP
C7- CC6- ZL1- RW-GB

9

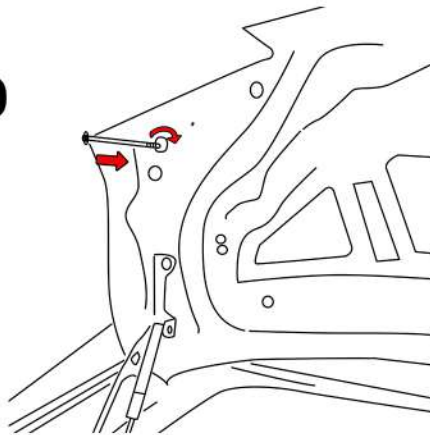

- Place a washer on the long bolts and install them the back mounting point of the driver and passenger side uprights.

10

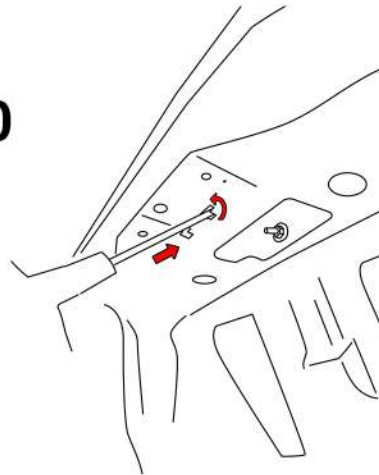

- Once the driver and passenger side uprights are installed, screw in the long bolt that was previously installed in the center of the trunk.